

**TORRETTE RADIALI  
RADIAL TURRETS  
RADIAL REVOLVER**

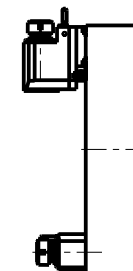

**TORRETTE ASSIALI  
AXIAL TURRETS  
AXIAL REVOLVER**



- Chiave inclusa
- Key included
- Schluessel inbegriffen

Cod. MT	Mandrino Spindle Spindel	I (n1:n2)	RPM max n2	Coppia Max Max Torque Max Drehmoment M2 [Nm]	Lubrificazione int. Coolant through Innenkuehlung Pmax [bar]	Lubr.esterna Ext. coolant Aussenkuehlung	Lav. secco Dry-run Trocken Bearb.	A	B	CHIAVI NON INCLUSE Keys not included Schluessel nicht einbegriffen		
OKU1120120	ER20	1:1	6000	32	-	X	X	41.16	73.5	-	CHSTER20	OKU0290009 *
OKU1120220	ER20	1:1	6000	32	100 (diag. 2)	X	X	41.16	83.5	-	CHSTER20	OKU0290009 *
OKU1120320	ERA20	1:1	6000	32	-	X	X	24.5	73.5	CHUB22	CHTAER20ZC *	OKU0290009 *
OKU1120420	ERA20	1:1	6000	32	100 (diag. 2)	X	X	24.5	83.5	CHUB22	CHTAER20ZC *	OKU0290009 *
OKU1120125	ER25	1:1	6000	32	-	X	X	42.16	73.5	-	CHSTER25	OKU0290009 *
OKU1120225	ER25	1:1	6000	32	100 (diag. 2)	X	X	42.16	83.5	-	CHSTER25	OKU0290009 *
OKU1120325	ERA25	1:1	6000	32	-	X	X	28.5	73.5	CHUB27	CHTAER25ZC *	OKU0290009 *
OKU1120425	ERA25	1:1	6000	32	100 (diag. 2)	X	X	28.5	83.5	CHUB27	CHTAER25ZC *	OKU0290009 *

**OKUMA**  
MOD: LB200 - GENOS L200M - GENOS L2000e M/MY - ES L6 M - ES L8II M - LB10M - LR10M - LU200M

MODULO MOTORIZZATO RADIALE ARRETRATO VD130  
Radial rear-set driven tool VD130  
Radial angetriebenes Werkzeug zurueckversetzt VD130

Subject to change without notice.

**M.T. srl**  
Via Casino Albini 480  
Tel. 0541/956034-957884  
Fax 0541/956341  
47842 S. GIOVANNI IN M. (RN)  
e-mail: mtma@mtmarchetti.com  
http://www.mtmarchetti.com



OKU015-1-00