

**TORRETTE ASSIALI  
AXIAL TURRETS  
AXIAL REVOLVER**

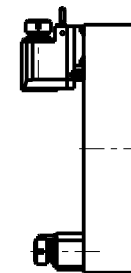

**ATTENZIONE - ATTENTION - ACHTUNG**

- Per lo smontaggio degli utensili utilizzare sempre la chiave di contrasto come indicato nel manuale d'uso.
- For disassembly of the tools use always the contrast key as mentioned in the user instructions.
- Fuer das Abmontieren der Werkzeuge immer den Gegenschlüssel benutzen wie in der Bedienungsanleitung erwäehnt.

- Chiave inclusa
- Key included
- Schluessel inbegriffen

Cod. MT	Mandrino Spindle Spindel	I (n1:n2)	RPM max n2	Coppia Max Max Torque Max Drehmoment M2 [Nm]	Lubrificazione int. Coolant through Innenkuehlung Pmax [bar]	Lubr.esterna Ext. coolant Aussenkuehlung	Lav. secco Dry-run Trocken Bearb.	A	A1	B	D	L	CHIAVI NON INCLUSE Keys not included Schluessel nicht einbegriffen	
OKU0040332	ER32	1:1	4000	70	-	X	X	99.7	-	58.5	-	-	OKU0650004	CHSTER32
OKU0040432	ER32	1:1	4000	70	100 (diag. 2)	X	X	99.7	-	69.5	-	-	OKU0650004	CHSTER32
OKU0040340	ER40	1:1	4000	70	-	X	X	103.7	-	58.5	-	-	OKU0650004	CHSTER40
OKU0040440	ER40	1:1	4000	70	100 (diag. 2)	X	X	103.7	-	69.5	-	-	OKU0650004	CHSTER40
OKU0041022	Ø22x19	1:1	4000	70	-	X	X	-	78.5	58.5	22	19	CHUB41	CH_VTCROCE_M10
OKU0041027	Ø27x21	1:1	4000	70	-	X	X	-	78.5	58.5	27	21	CHUB41	CH_VTCROCE_M12

OKUMA

MOD: LB25/400 - LR25 - LU25M - LU400M

MODULO MOTORIZZATO RADIALE VDI40 H=75mm

Radial driven tool VDI40 H=75mm

Radial angetriebenes Werkzeug VDI40 H=75mm

Subject to change without notice.

**M.T. srl**

Via Casino Albini 480  
Tel. 0541/956034-957884  
Fax 0541/956341  
47842 S. GIOVANNI IN M. (RN)  
e-mail: mtma@mtmarchetti.com  
http://www.mtmarchetti.com



OKU013-3-10