

## CUSCINETTI MAGGIORATI PER LAVORAZIONI PESANTI

Reinforced bearings for  
heavy machining

Vergroesserte Lager fuer  
schwerere Bearbeitungen

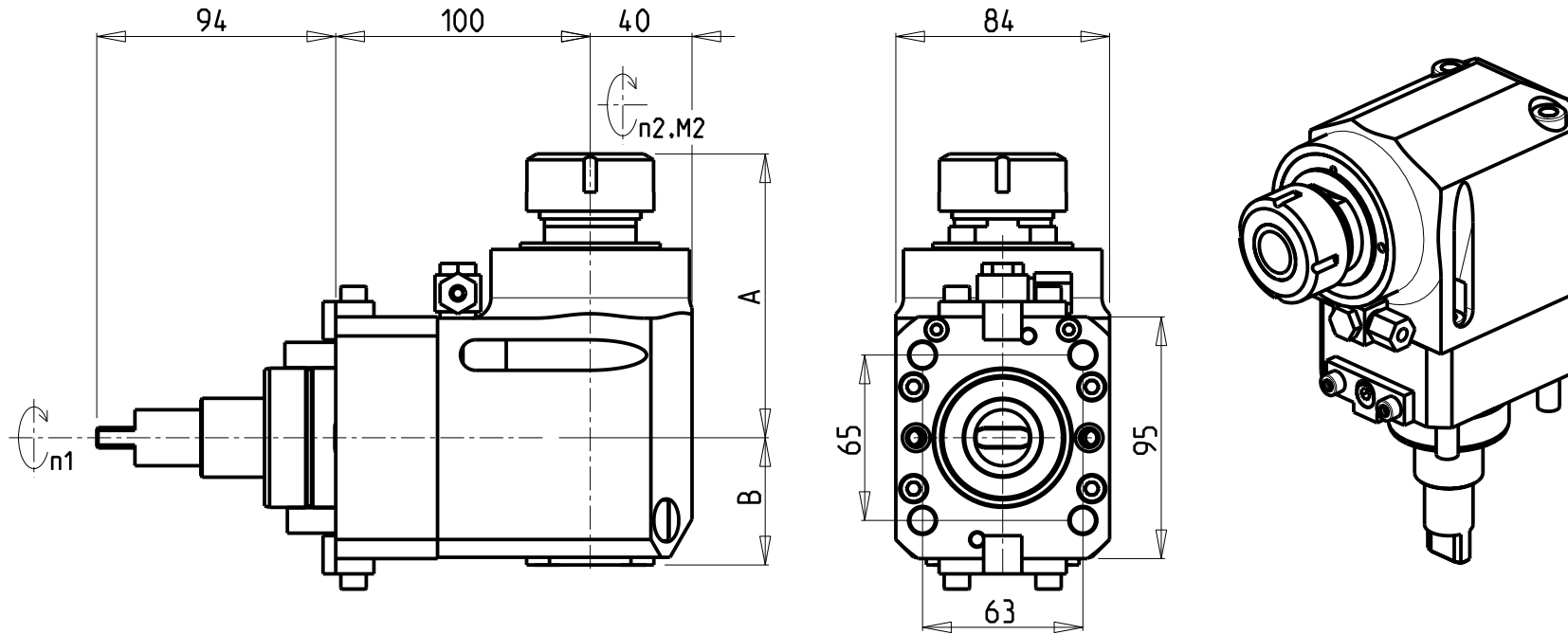

Cod. MT	Mandrino Spindle Spindel	I (n1:n2)	RPM max n2	Coppia Max Max Torque Max Drehmoment M2 (Nm)	Reversibile 180° 180° Reversible 180° umsetzbar	Lubrificazione int. Coolant through Innenkuehlung Pmax (bar)	Lubr.esterna Ext. coolant Aussenkuehlung	Lav. secco Dry-run Trocken Bearb.	A	B	CHIAVI NON INCLUSE Keys not included Schluessel nicht einbegriffen	
0391432L	ER32	1:1	6000	70	X	-	X	X	112.16	50	CHSTER32	CHUB36
0391032L	ER32	1:1	6000	70	X	100 (diag. 2)	X	X	112.16	61	CHSTER32	CHUB36
0391532L	ERA32	1:1	6000	70	X	-	X	X	99.03	50	CHUB50	CHUB32
0392640L	ER40	1:1	6000	70	X	-	X	X	115.16	50	CHSTER40	CHUB46
0392540L	ER40	1:1	6000	70	X	100 (diag. 2)	X	X	115.16	61	CHSTER40	CHUB46

**BIGLIA**

MOD: B445/470/545/550/565/650/658/1200/446/465/745/765 - B750/1250 16 ST.

MODULO MOTORIZZATO ASSIALE MAGGIORATO H=100mm

Axial reinforced driven tool H=100mm

Axial angetriebenes Werkzeug vergroessert H=100mm

Subject to change without notice.

**M.T. srl**

Via Casino Albini 480  
Tel. 0541/956034-957884  
Fax 0541/956341  
47842 S. GIOVANNI IN M. (RN)  
e-mail: mtma@mtmarchetti.com  
http://www.mtmarchetti.com



BGL170-1-20

09/2025